

Single & Twin Screw Feeder with or without Agitation

Typical application of AS25:

- A. Motor Control
- B. Single Screw Feeder

Typical application of AT16:

- A. Motor Control
- B. Twin Screw Feeder

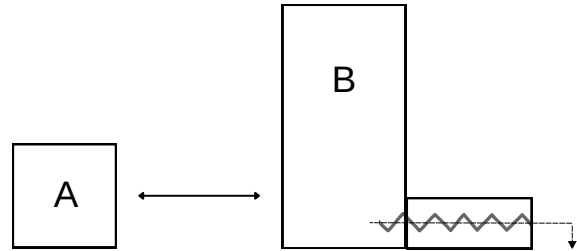
Description



Orbetron's AS25 / AT16 feeders are designed to feed free-flowing materials and poor-flowing powders at very low rates.

The removable feed hopper makes it ideal for applications that require quick material changes by removing the existing hopper and replacing it with a new clean hopper. The removable feed hopper can also be used as a storage container, eliminating cleaning and the possibility of product contamination. These include a single screw hopper to feed free-flowing products, and a twin screw with a horizontal agitator to feed materials. The feeder can be easily integrated with gravimetric or volumetric controls, as well as installed separately or in a production line with multiple feeding devices.





Dosing Performance

AS25 is displayed above.

AS25

Screw Type		F 		S 	
		Full-Flight		Spiral	
Gear Reducer	Speed (rpm)	Ø 12 x 5 dm ³ /h	Ø 17 x 17 dm ³ /h	Ø 15 x 11 dm ³ /h	Ø 20 x 11 dm ³ /h
6:1	12-500	0.15-6	1.08-45	0.6-24	1.02-42
21:1	4-143	0.04-2	0.3-13	0.18-7	0.3-12
36:1	2-83	0.025-1	0.18-8	0.1-4	0.17-7
Gear Reducer	Speed (rpm)	Ø 20 x 15 dm ³ /h		Ø 30 x 16 dm ³ /h	Ø 30 x 32 dm ³ /h
6:1	12-500	1.8-75		2.88-120	7.08-294
21:1	4-143	0.5-21		0.8-34	2-84
36:1	2-83	0.3-12		0.48-20	1.18-49

AT16

Screw Type		C 	F 	S 
		Double Concave	Double Full-Flight	Double Spiral
Gear Reducer	Speed (rpm)	Ø 13 x 11 dm ³ /h	Ø 12 x 5 dm ³ /h	Ø 14 x 10 dm ³ /h
6:1	14-580	0.60-24	0.3-12	1.5-60
21:1	4-166	0.2-7	0.08-3	0.4-17
36:1	2.3-96	0.10-4	0.05-2	0.25-10
Gear Reducer	Speed (rpm)	Ø 14 x 15 dm ³ /h	Ø 14 x 20 dm ³ /h	Ø 14 x 20 dm ³ /h
6:1	14-580	1.2-48	2.4-96	3.6-150
21:1	4-166	0.3-14	0.07-27	1.0-43
36:1	2.3-96	0.2-8	0.4-16	0.6-25

Design

- Compact feeder and gearbox design
- High modularity for easy dismantling and cleaning
- Horizontal material outlet discharge
- Tool-free change of the feeder screw
- Applicable for single spiral and auger screws
- All metal parts which are in material contact are in stainless steel 1.4404 (AS1316L)
- Mechanical gearbox with lifetime lubrication
- Motor configuration AC/DC, Stepper
- Gearboxes in multiple configurations
- Weight without accessories volumetric 6kg
- Gravimetric 13kg
- Exchange hopper 9kg

Options

- Gravimetric and volumetric controls
- Hopper extension modules
- Special hoppers are available by request
- Removable vertical outlet tube with the size of 4"
- Counter bearing for very poor flowing or heavy materials
- Silicon sealing
- Gravimetric loss-in-weight batch
- Gravimetric gain-in-weight
- Gravimetric low-in-weight continuous
- Volumetric continuous or batch
- Ezi-Dock adaptation for material containment
- Integration with OSB Series
- Vertical Discharge

Drawings

AS25

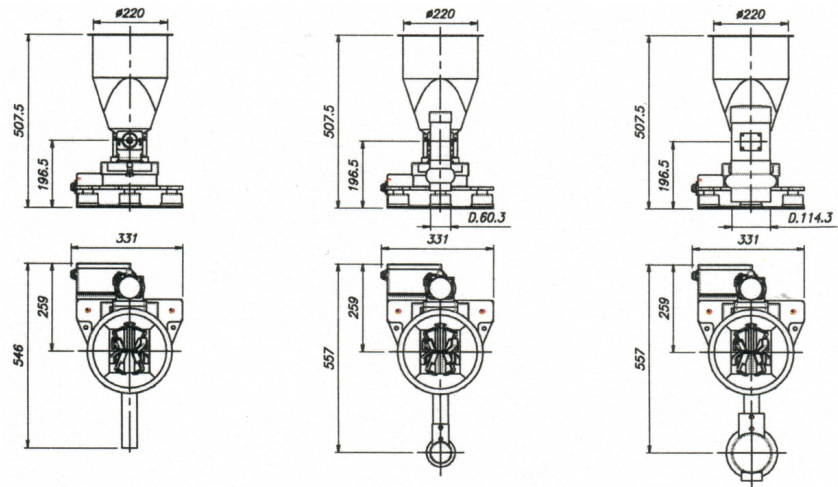

AT16

